

VERSA STEEL Approval Drawings

BASEMENT DOOR HATCH 48 X 67, MECHANICAL STOP

Assembly No.:VSH-B-S-48-67-D-S

ASSEMBLY NO./PART NUMBER KEY:

VSH= VERSA STEEL INC. HATCH
 B = BASEMENT 40 P.S.F. RATED
 S= STEEL CONSTRUCTION
 48-67= SIZE INTERIOR OPENING
 D = DUAL LEAF SERIES
 GS= GAS SPRING

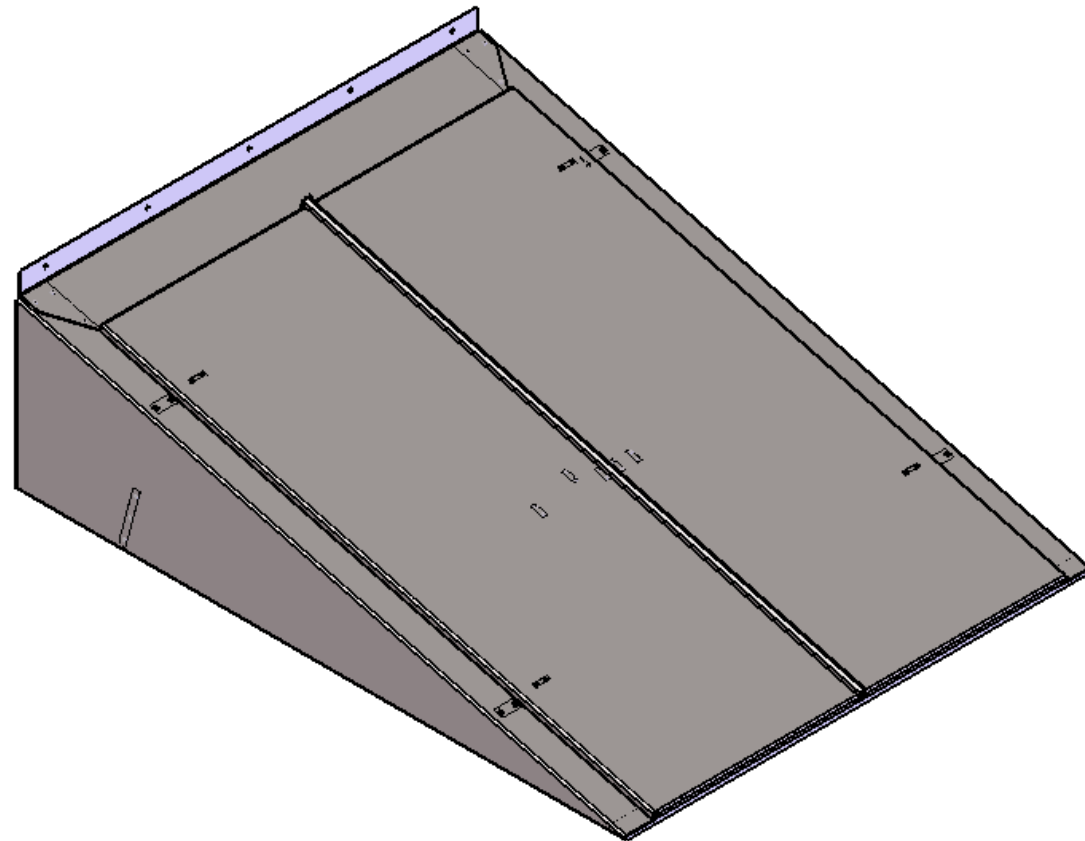

GENERAL SPECIFICATIONS:

1. UNIT IS WEATHER PROOF WITH OVERLAPPING JOINTS TO SHED RAIN.
2. FRAME AND LID ARE MANUFACTURED FROM HIGH GRADE GALVANIZED SHEET STEEL, .090" THICK. OPTIONS AVAILABLE: PRIMED ONLY OR PRIMED AND PAINTED.
3. FRAME FLANGES WITH MOUNTING HOLES TO MOUNT TO CONCRETE CURB AND FLANGES TO MOUNT TO WALL SURFACE.
4. DOORS ARE HINGED WITH ARTICULATED HINGE JOINT.
5. HATCH IS DESIGNED FOR 40 P.S.F. LOAD.
6. ALL FASTENERS AND HARDWARE ARE 316 STAINLESS STEEL.
7. GAS SPRING OPTION: GAS SPRING ASSIST TO AID IN OPENING HATCH.
8. MECHANICAL STOP OPTION: MECHANICAL LOCK ARM TO HOLD THE LID OPEN, WITH A MANUALLY RELEASE MECHANISM.
9. SLIDE LOCK MECHANISM OPERATED FROM THE INSIDE.
10. EXTERNAL LIFTING HANDLE PROVIDED.
11. OPTIONS AVAILABLE: EXTERIOR LOCK AND ACCESS HANDLES.

THIS DOCUMENT CONTAINS PROPRIETARY, TRADE SECRET INFORMATION THAT IS THE PROPERTY OF VERSA STEEL, INC. THE INFORMATION CONTAINED IN THIS DOCUMENT, INCLUDING THE PRINCIPLE OF DESIGN, MAY NOT BE USED OR COPIED, IN WHOLE OR IN PART, WITHOUT THE EXPRESS PRIOR WRITTEN CONSENT OF VERSA STEEL, INC.

	VERSA STEEL, INC. 1618 NE FIRST AVENUE PORTLAND, OREGON 97232 (503)287-9822 FAX (503)-287-7483			
DRAWN BY	E. BAILIFF	ISSUED FOR		BY
DATE	2011-02-09	REV	A	DATE
CHECKED BY				
APPROVED BY				
MATERIAL		SHEET TITLE	BASEMENT DOOR HATCH 48 X 67, MECHANICAL STOP	
FINISH		PART NUMBER	VSH-B-S-48-67-D-S	
		SUPPLIER	VSH-B-S-48-67-D-S	
SCALE	1:16			
DRAWING NO.	VSH-B-S-48-67-D-S-APPROV			
REVISION NO.	A			
SHEET NO.	1	OF	3	

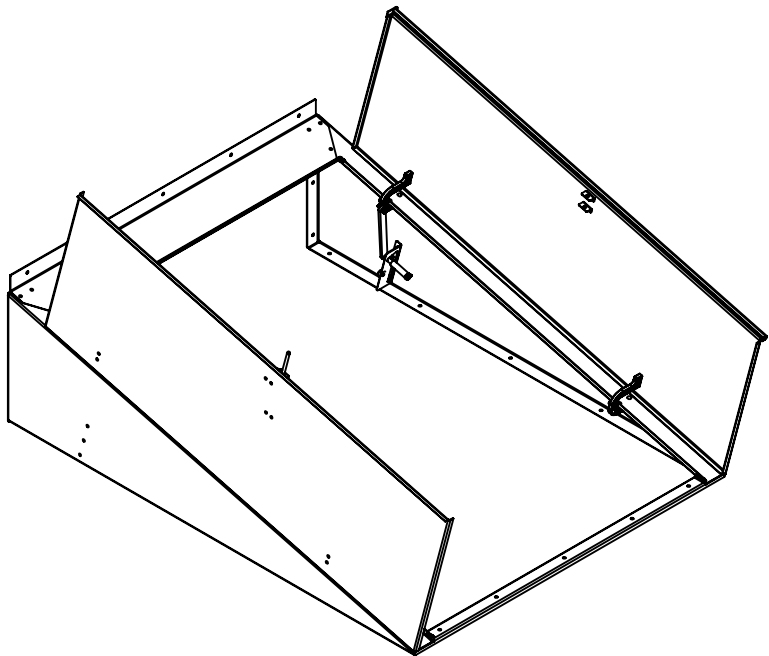
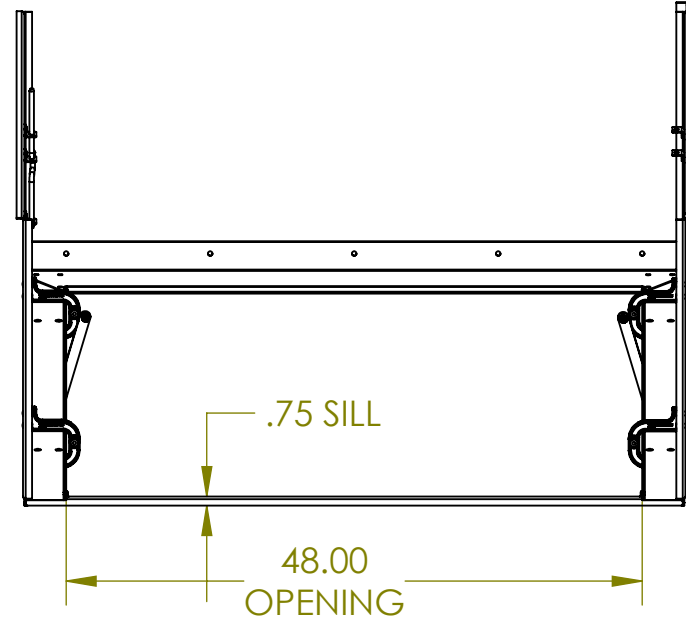
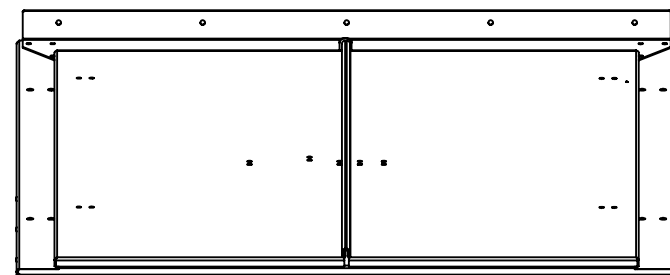
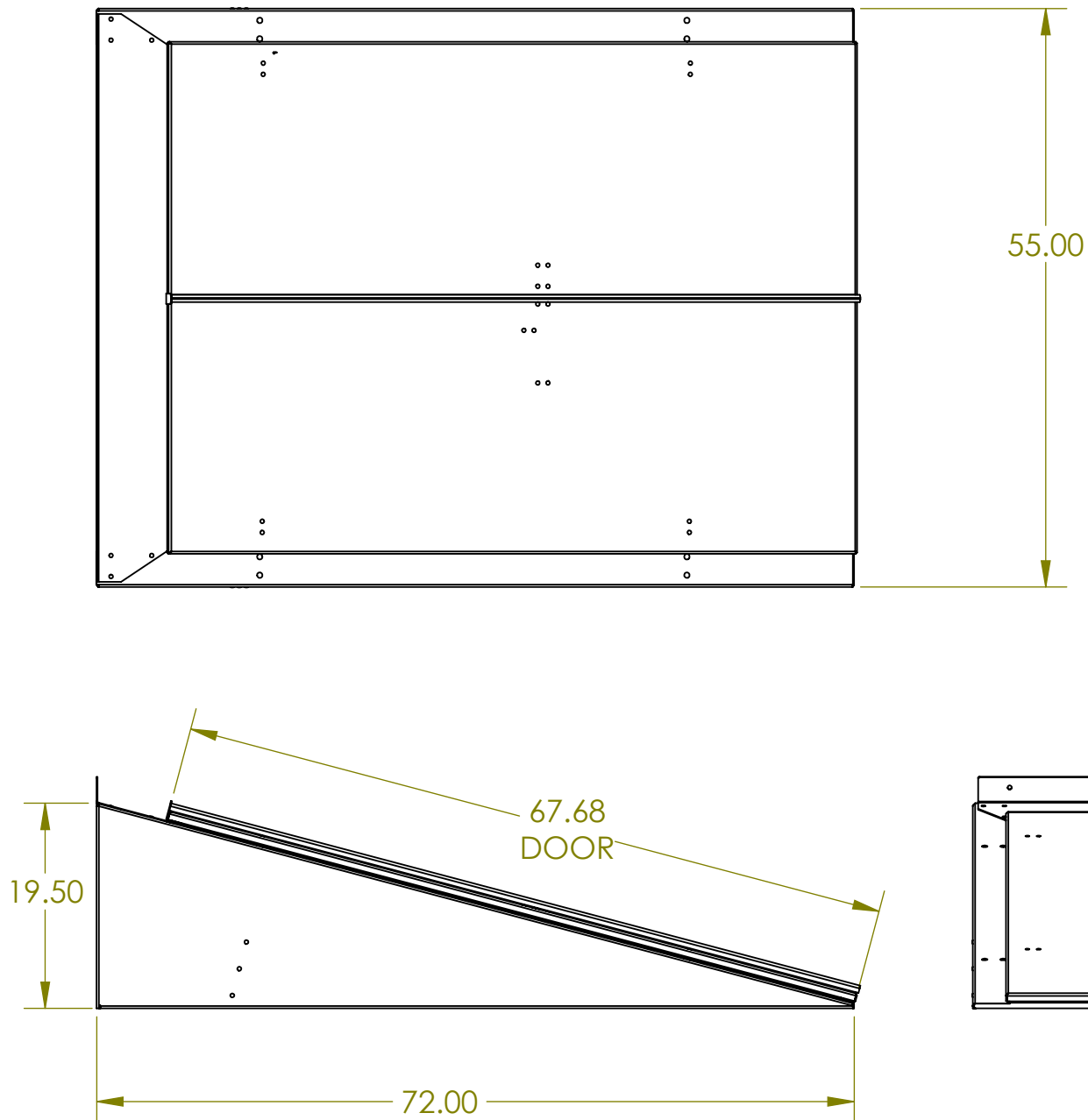

NOTES:
 PN: VSH-B-S-48-67-D-S
 DESC: BASEMENT DOOR HATCH 48 X 67, MECHANICAL STOP
 MATRL:
 EST. WT: 180.12
 FINISH:
 NOTE:
 CAD FILE: VSH-B-S-48-67-D-S-APPROVAL

TOLERANCES:
 DIMENSIONS ARE IN INCHES
 TOLERANCES:
 X.XX ± 0.020"
 X.XXX ± 0.005"
 UNLESS NOTED

THIS DOCUMENT CONTAINS PROPRIETARY, TRADE SECRET INFORMATION THAT IS THE PROPERTY OF VERSA STEEL, INC. THE INFORMATION CONTAINED IN THIS DOCUMENT, INCLUDING THE PRINCIPLE OF DESIGN, MAY NOT BE USED OR COPIED, IN WHOLE OR IN PART, WITHOUT THE EXPRESS PRIOR WRITTEN CONSENT OF VERSA STEEL, INC.

MATERIAL	
FINISH	
SHEET TITLE	BASEMENT DOOR HATCH 48 X 67, MECHANICAL STOP
PART NUMBER	VSH-B-S-48-67-D-S
SUPPLIER	
SCALE	1:16
DRAWING NO.	VSH-B-S-48-67-D-S-APPROVAL
REVISION NO.	A
SHEET NO.	2 OF 3
DRAWN BY	E. BAILIFF
DATE	2011-02-09
CHECKED BY	
APPROVED BY	
REV	A
ISSUED FOR	
DATE	
BY	
REV	B
ISSUED FOR	
DATE	
BY	
REV	C
ISSUED FOR	
DATE	
BY	
REV	D
ISSUED FOR	
DATE	
BY	
REV	E
ISSUED FOR	
DATE	
BY	
REV	F
ISSUED FOR	
DATE	
BY	
REV	G
ISSUED FOR	
DATE	
BY	

VERSA STEEL, INC.
 1618 NE FIRST AVENUE
 PORTLAND, OREGON 97232
 (503)287-9822
 FAX (503)-287-7483

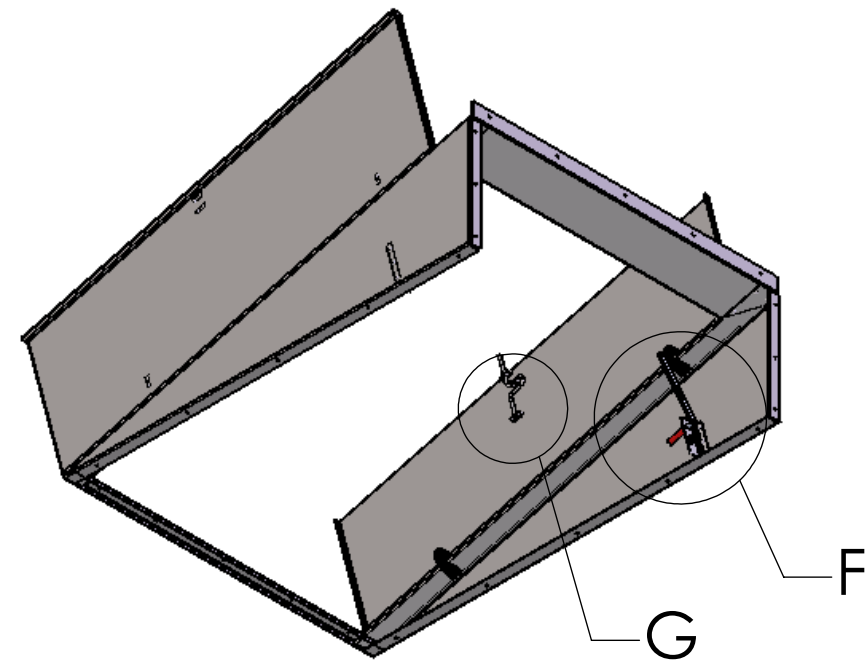
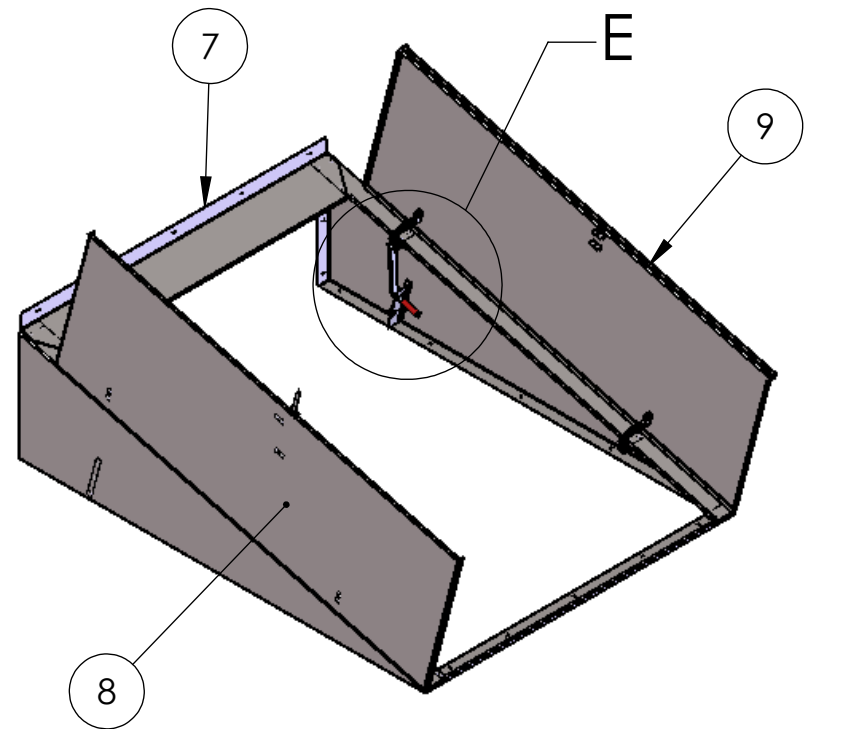

ITEM NO.	PART NUMBER	DESCRIPTION	QTY
1	1000756	Clevis Pin 3/8x1.25	4
2	97550A310	RIVET, .187 X .079-.157, 316	2
3	1000657	Shoulder Bolt 3/8x 1/2	2
4	1000060	SHOULDER SCREW 1/2"OD X 3/8-16 UNC X 4" LG	2
5	9446K71	LOCK BAR COVERING, GP PVC TUBING, RED	2
6	STOP ARM	STOP ARM	2
7	7000586-DT	FRAME ASSEMBLY, BASEMENT	1
8	7000587-DT	DOOR, RH, BASEMENT HATCH	1
9	7000587-DT	DOOR, RH, BASEMENT HATCH	1

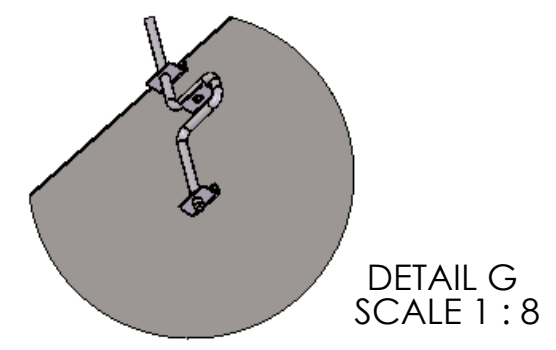
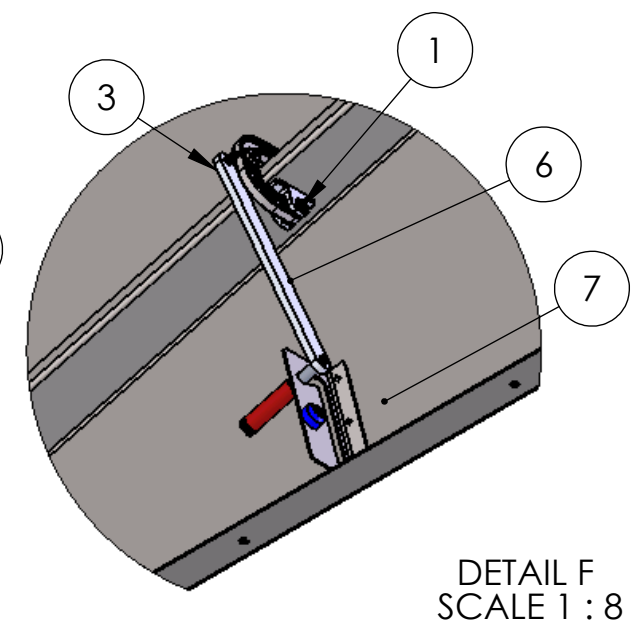
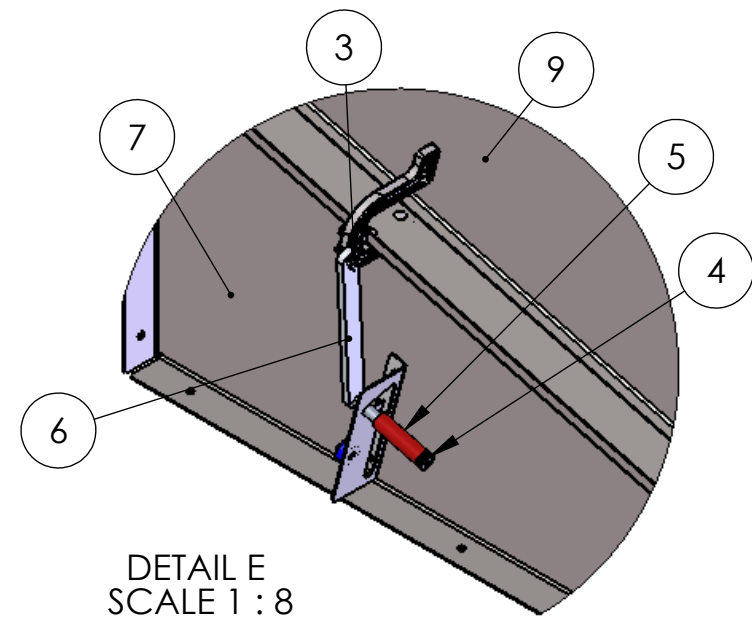

NOTES:
 PN: VSH-B-S-48-67-D-S
 DESC: BASEMENT DOOR HATCH 48 X 67, MECHANICAL STOP
 MATRL:
 EST. WT: 180.12
 FINISH:
 NOTE:
 CAD FILE: VSH-B-S-48-67-D-S-APPROVAL

THIS DOCUMENT CONTAINS PROPRIETARY, TRADE SECRET INFORMATION THAT IS THE PROPERTY OF VERSA STEEL, INC. THE INFORMATION CONTAINED IN THIS DOCUMENT, INCLUDING THE PRINCIPLE OF DESIGN, MAY NOT BE USED OR COPIED, IN WHOLE OR IN PART, WITHOUT THE EXPRESS PRIOR WRITTEN CONSENT OF VERSA STEEL, INC.

VERSA STEEL, INC. 1618 NE FIRST AVENUE PORTLAND, OREGON 97232 (503)287-9822 FAX (503)-287-7483		G F E D C B A	REV _____ _____ _____ _____ _____ _____ _____	ISSUED FOR _____ _____ _____ _____ _____ _____ _____	DATE _____ _____ _____ _____ _____ _____ _____	BY _____ _____ _____ _____ _____ _____ _____
DRAWN BY E. BAILIFF						
DATE 2011-02-09						
CHECKED BY _____						
APPROVED BY _____						
MATERIAL _____						
FINISH _____						
SHEET TITLE BASEMENT DOOR HATCH 48 X 67, MECHANICAL STOP						
PART NUMBER VSH-B-S-48-67-D-S						
SUPPLIER _____						
SCALE 1:24						
DRAWING NO. VSH-B-S-48-67-D-S-APPROVAL						
REVISION NO. A						
SHEET NO. 3 OF 3						