

VERSA STEEL Approval Drawings

HATCH ASSEMBLY, DOUBLE LEAF 42 X 48

Assembly No.:VSH-150-A-42-48-D-NS

ASSEMBLY NO./PART NUMBER KEY:

VSH= VERSA STEEL INC. HATCH
 150 = 200 P.S.F. RATED
 A= ALUMINUM CONSTRUCTION
 30-30= SIZE INTERIOR OPENING
 S = SMALL SERIES
 GS= GAS SPRING
 NS= NO SPRING ASSIST

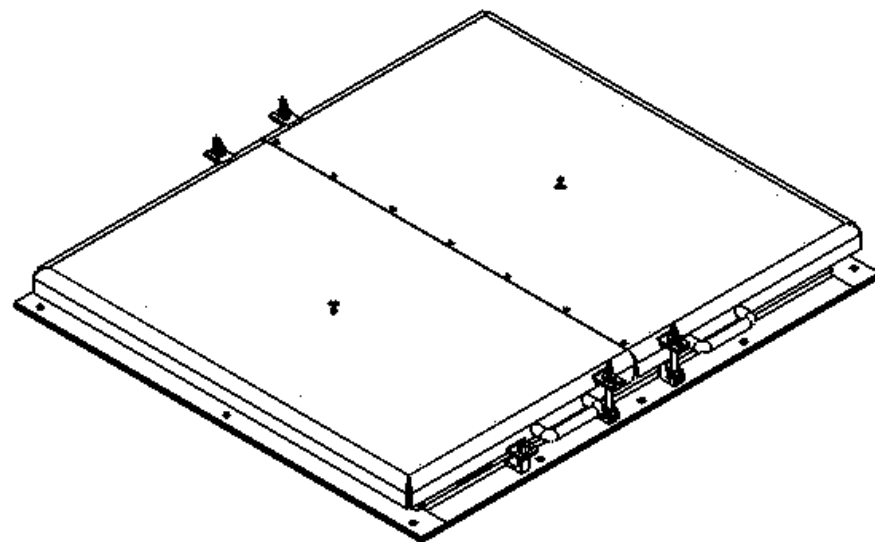

GENERAL SPECIFICATIONS:

- UNIT IS WEATHER PROOF WITH CONTINUOUS BULB SEAL ON LID TO FRAME AND 1/4" X 3" WIDE FRAME TO CURB SEALS.
- LID OVER LAPS FRAME A MINIMUM OF 2 INCHES.
- FRAME IS A MINIMUM OF 4" ABOVE THE CURB.
- LID IS HINGED ON SIDE WITH TAMPER PROOF SCREWS . THERE ARE A MINIMUM OF THREE SWING BOLT HOLD DOWNS TO SECURE THE HATCH FOR WEATHER PROOF SEAL.
- HATCH IS DESIGNED FOR 150 P.S.F. LOAD.
- THERE ARE 8 EXTERIOR ATTACHMENT POINTS FOR 1/2" FASTENER. THERE IS A FULL FACE GASKET OF 3" WIDE CLOSED CELL FOAM EPDM BETWEEN FRAME AND CURB.
- LID IS A 1/4" 5086 FORMED ALUMINUM TREAD PLATE.
- ALL FASTENERS AND HARDWARE ARE 316 STAINLESS STEEL.
- ONE COAT OF BLACK BITUMINOUS PAINT ON THE INSIDE OF FRAME WHERE IT CONTACTS CURBING CONCRETE.

THIS DOCUMENT CONTAINS PROPRIETARY, TRADE SECRET, INFORMATION THAT IS THE PROPERTY OF VERSA STEEL, INC. THE INFORMATION CONTAINED IN THIS DOCUMENT, INCLUDING THE PRINCIPLE OF DESIGN, MAY NOT BE USED OR COPIED, IN WHOLE OR IN PART, WITHOUT THE EXPRESS PRIOR WRITTEN CONSENT OF VERSA STEEL, INC.

G	F	E	D	C	B	A
REV	ISSUED FOR	DATE	BY			

VERSA STEEL, INC.
 1618 NE FIRST AVENUE
 PORTLAND, OREGON 97232
 (503)287-9822
 FAX (503)-287-7483

DRAWN BY
 E.BAILIFF

DATE
 2009-08-05

CHECKED BY

APPROVED BY

MATERIAL	HATCH ASSEMBLY, DOUBLE LEAF 42 X 48	PART NUMBER: VSH-150-A-42-48-D-NS
FINISH		
SHEET TITLE		

PART NUMBER
 VSH-150-A-42-48-D-NS
 SUPPLIER

SCALE
 1:16

DRAWING NO.
 VSH-150-A-42-48-D-NS

REVISION NO.
 A

SHEET NO.
 1 OF 2

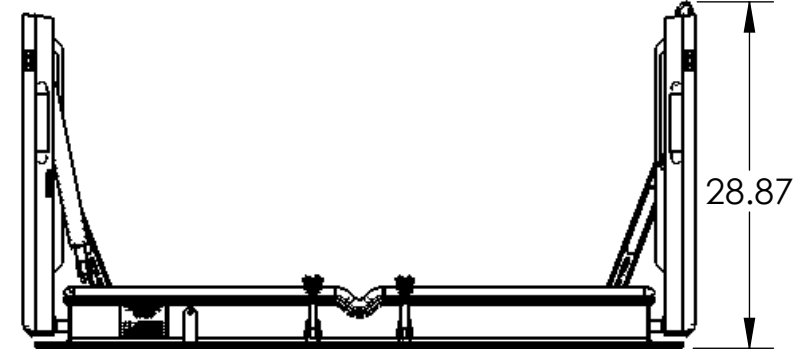
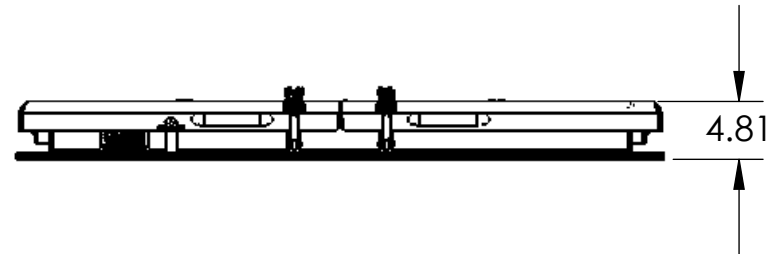
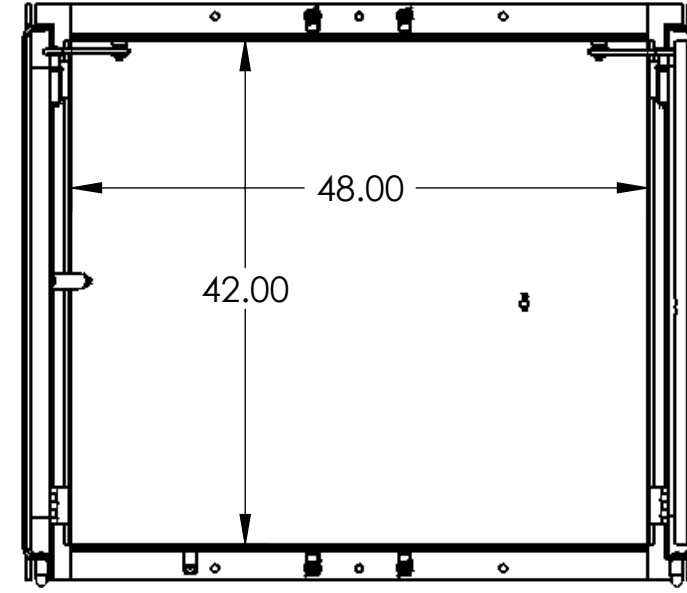
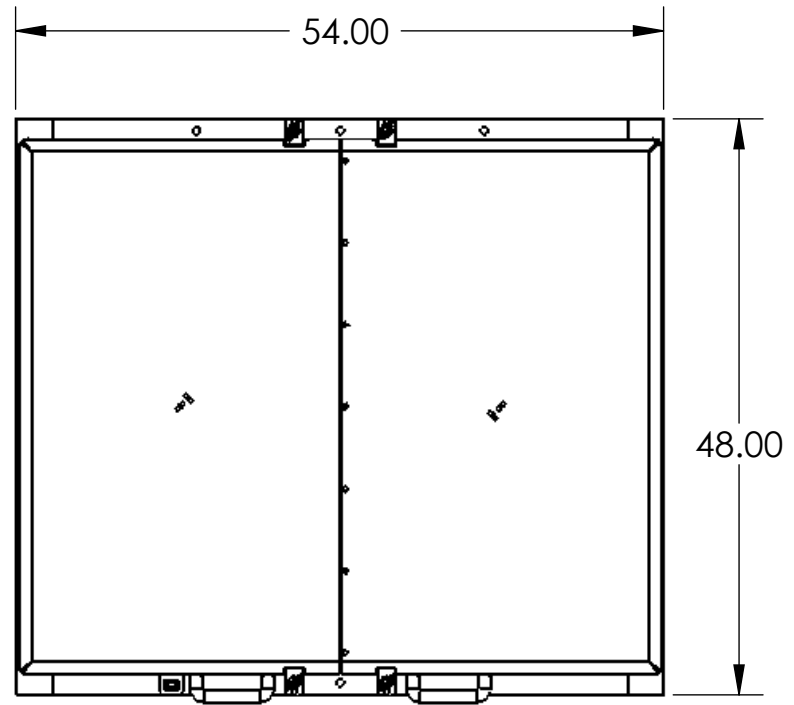

NOTES:
 PN: VSH-150-A-42-48-D-NS
 DESC: HATCH ASSEMBLY, DOUBLE LEAF 42 X 48
 MATRL:
 EST. WT: 101.98
 FINISH:
 NOTE: ERROR!:note
 CAD FILE: VSH-150-A-42-48-D-NS

THIS DOCUMENT CONTAINS PROPRIETARY, TRADE SECRET INFORMATION THAT IS THE PROPERTY OF VERSA STEEL, INC. THE INFORMATION CONTAINED IN THIS DOCUMENT, INCLUDING THE PRINCIPLE OF DESIGN, MAY NOT BE USED OR COPIED, IN WHOLE OR IN PART, WITHOUT THE EXPRESS PRIOR WRITTEN CONSENT OF VERSA STEEL, INC.

MATERIAL FINISH SHEET TITLE HATCH ASSEMBLY, DOUBLE LEAF 42 X 48 PART NUMBER: VSH-150-A-42-48-D-NS		DRAWN BY E. BAILIFF	DATE 2009-08-05	CHECKED BY	APPROVED BY
PART NUMBER VSH-150-A-42-48-D-NS SUPPLIER		VERSA STEEL, INC. 1618 NE FIRST AVENUE PORTLAND, OREGON 97232 (503)287-9822 FAX (503)-287-7483			
SCALE 1:16		G F E D C B A			
DRAWING NO. VSH-150-A-42-48-D-NS REVISION NO. A		REV ISSUED FOR DATE BY			
SHEET NO. 2 OF 2					